

mater

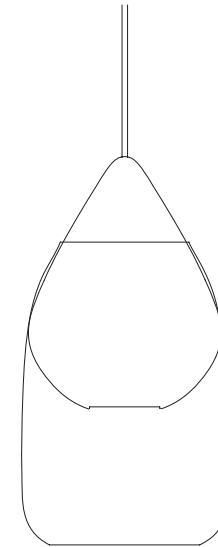

Considering the planet,
its resources and its people.

@materdesign

www.materdesign.com

Liuku Pendant Drop W/ Shade

Designed by Maija Puoskari

Thank you for purchasing the Liuku Pendant

Liuku Pendant Drop W/ Shade

Linden wood & mouth blown glass



Designed by
Maija Puoskari

Dimensions
Ø 19,5 cm H 40,5 cm / Ø 7.7" H 15.9"

Weight
3 kg / 6.6 lbs

Cord length
2 m / 78"

Canopy
Included

Materials
Solid linden wood with fabric cord
and mouth blown glass shade.

Colours
Wood: Black Stained / Matt Lacquered
Glass: Transparent / Smoked

Light Source
GU10 max 4W LED. Bulb not
included.

Certifications
CE   

Maintenance guide

For daily care, it is recommended to dust the lamp with a soft cloth. The product can also be cleaned with a soft cloth wrung in a mild solution of lukewarm water and a universal cleaning detergent. Always follow the wood grains and wipe with a soft dry cloth immediately afterwards.

Avoid using abrasive and aggressive cleaning detergents, as this will damage the surface of the lacquered or stained wood. Avoid placing wooden furniture in direct sunlight, excessive heat, or humidity, as this can interfere with the appearance of the wood.

Clean the glass using a dry soft cloth. If the glass needs a more thorough cleaning, it is recommended to use a soft cloth in combination with a standard glass cleaning detergent. Avoid using abrasive cleaning agents on the glass as this will damage the surface.

Important:
Wood is a natural material that expands and contracts depending on air temperature and humidity. Therefore, we recommend carefully loosening the glass from the wooden part once a month to avoid any tension to the glass shade.

9

Install the recommended light source.

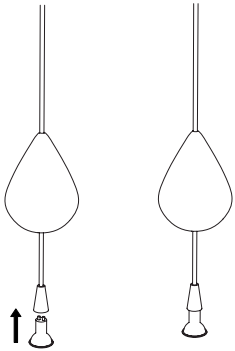

10

Place the glass shade back onto the lamp.

Now you can enjoy your Liuku Pendant.

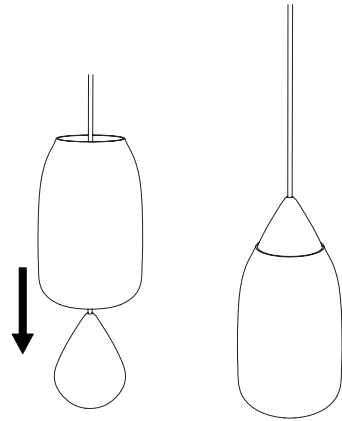

Installation Guide

Components

1x Pendant



1 x glass shade

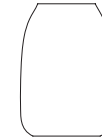

1 x Canopy



1 x Metal bracket



1 x Wire fixture



1 x Plastic screw



1 x Nut



2 x Screws



Safety precautions

Consult a professionally qualified electrician if in any doubt. Before starting the installation, disconnect the power supply by turning off the circuit breaker or by removing the fuse at the power off. Using the light switch is not sufficient to prevent electrical shock.

1

Before you start the electrical installation, carefully place the glass shade onto the pendant. We recommend that two people install the lamp to prevent the glass from breaking.

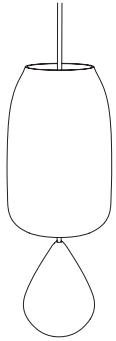

2

Ensure the power supply is turned off. Mount the metal bracket securely to the ceiling with screws and wall plugs appropriate for the ceiling. Note that screws and plugs for the ceiling are not included.

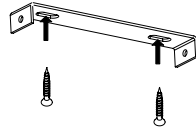

5

Assemble the canopy to the metal bracket mounted in the ceiling using the two small screws.

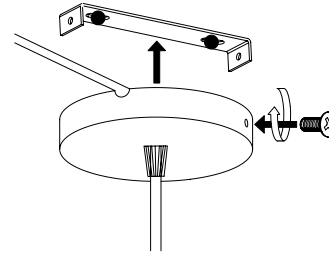

6

Ensure the power supply is turned off. Remove any frame or cover from the electric outlet where you want to install the lamp. Mount the cover or frame onto the cord before installing the lamp.

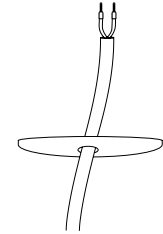

3

Assemble the canopy using the nut and wire fixture.

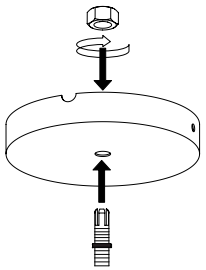

4

To determine the right height for the lamp, pass the electrical cord through the plastic screw and then through the wire fixture. Tighten the plastic screw around the wire fixture when you have the desired length.

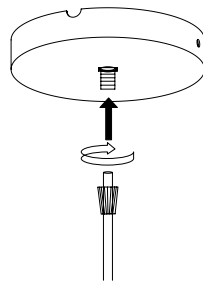

7

Connect the brown wire (L) to M1 in the electric outlet and the blue wire (N) to N in the electric outlet.

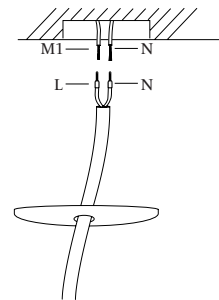

8

To install the light bulb, separate the glass shade from the lamp and pull the cord out of the lamp.

